

# MCR SERIES

## ELECTRIC COUNTER

### DESCRIPTION

The MCR Series is a robust medium sized electric totalizer designed for general counting purposes. Available in 4,5 and 6 digit models with different mounting options. Suitable for business machines, amusement and coin operated equipment, textile machinery, printing presses, machine tools, etc.

### MODELS

TYPE	MODELS	DIGITS	VOLTAGE	MOUNTING	WEIGHT	
Additive Total Counter	MCR-4PN DC24V	4	DC24V	Panel (Screw)	260 grams [9.17oz.]	
	MCR-4PN AC100V		AC100V			
	MCR-4PN AC200V		AC200V			
	MCR-5PN DC24V	5	DC24V			
	MCR-5PN AC100V		AC100V			
	MCR-5PN AC200V		AC200V			
	MCR-6PN DC24V	6	DC24V		265 grams [9.35oz.]	
	MCR-6PN AC100V		AC100V			
	MCR-6PN AC200V		AC200V			
	MCR-6PNWUL DC24V		DC24V			
MCR-6PNWUL AC115V	AC115V					
TYPE	MODELS	DIGITS	VOLTAGE	MOUNTING	WEIGHT	
Additive Total Counter	MCR-4CN DC24V	4	DC24V	Base (Screw   Horizontal)	275 grams [9.70oz.]	
	MCR-4CN AC100V		AC100V			
	MCR-4CN AC200V		AC200V			
	MCR-5CN DC24V	5	DC24V			
	MCR-5CN AC100V		AC100V			
	MCR-5CN AC200V		AC200V			
	MCR-6CN DC24V	6	DC24V		280 grams [9.88oz.]	
	MCR-6CN AC100V		AC100V			
	MCR-6CN AC200V		AC200V			
	MCR-6CNUL DC24V		DC24V			
	MCR-6CNUL AC115V		AC115V			
	<del>Discontinued</del> MCR-5X	5	DC24V/AC100V/AC200V		Panel (Clamp)	320 grams [11.29oz.]
	<del>Discontinued</del> MCR-6X	6	DC24V/AC100V/AC200V			

### SPECIFICATIONS

Power Source	AC100V, 115V, 200V 50/60 Hz convertible / DC24V
Voltage Fluctuation	±10%
Power Consumption	AC : 3.5 - 4.2VA ; DC : 3.3W
Continuous Energizing	permissible
Counting Method	One pulse - One count (energizing - ½ count, unenergized - ½ count )
Counting Speed	15 Hz (maximum)
Pulse Width	33msec. minimum
Make (Duty)	1 : 1
Display	4 & 5 Digits: 5.4 x 3.8mm [0.21 x 0.13 "] / 6 Digits: 5.4 x 2.8mm [0.21 x 0.13 "] (white on black background)
Reset Time	Manual (push button)
Connection	PN Type : Soldering Terminal (Lead wires with terminal (260±5mm / [10.2±0.2 "] are included) CN/PNW Type : Lead wire (AWG22)
Operating Temperature	-5°C - +40°C [23 - 104 °F] (non-freezing)
Operating Humidity	85%RH maximum (non-condensing)
Test Voltage	AC1,500V for 1 minute
Insulation Resistance	50MΩ minimum (500VDC megger)
Vibration	Endurance : 16.7 Hz, Width, double amplitude 4mm [0.16 "] Malfunction : 10 - 55 Hz, double amplitude 0.5mm [0.02 "]
Shock	Endurance : 300 m/s <sup>2</sup> (30G) / Malfunction : 50 m/s <sup>2</sup> (5G)
Construction	PN & CN : Plastic (Black) / X : Plastic (Gray)

## DIMENSIONS - MILLIMETERS [INCH]

### MCR - 4PN • 5PN • 6PN

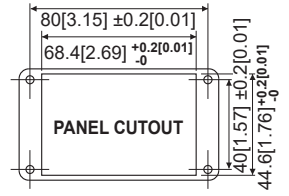
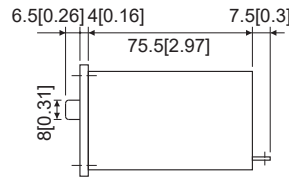
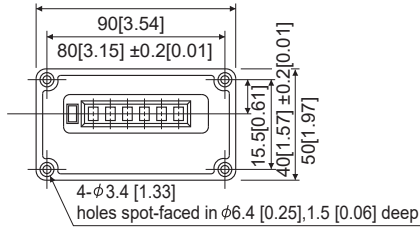

### MCR-6PNW

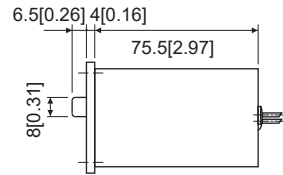

### MCR - 4CN • 5CN • 6CN

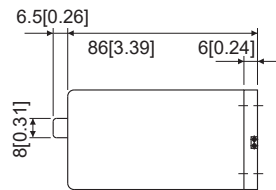
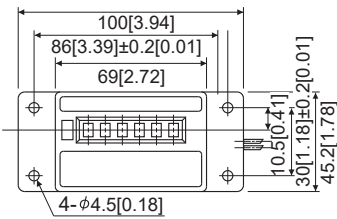

### ~~MCR-5X • 6X~~ Discontinued

