

# MZ SERIES

## MINIATURE NON-RESET ELECTRIC COUNTER

- Non-Reset, Super mini size
- Low Cost, Low power consumption
- Suitable for limited space installations in office equipment, amusement equipment, etc.
- Applications : Slot Machine, Copy Machine, Fax Machine, Vending Machine, Other Industrial Machine
- **MODELS**

TYPE	MODELS	DIGITS	VOLTAGE	MOUNTING	CONNECTION	
NON-RESET TOTAL COUNTER	MZ - 600 DC12V	6	DC12V	Rear (Screw   Mounting Pitch : 15 mm [0.59 "])	Lead wire	
	MZ - 600 DC24V		DC24V			
	MZ - 700 DC12V	7	DC12V			
	MZ - 700 DC24V		DC24V			
	MZ - 610 DC12V	6	DC12V	Rear (Screw   Mounting Pitch : 20 mm [0.79 "])		
	MZ - 610 DC24V		DC24V			
	MZ - 710 DC12V	7	DC12V			
	MZ - 710 DC24V		DC24V			
	MZ - 620 DC12V	6	DC12V	Base (Screw   Horizontal)		
	MZ - 620 DC24V		DC24V			
	MZ - 720 DC12V	7	DC12V			
	MZ - 720 DC24V		DC24V			
	MZ - 630 DC12V	6	DC12V	Behind panel (Screw)		
	MZ - 630 DC24V		DC24V			
MZ - 730 DC12V	7	DC12V				
MZ - 730 DC24V		DC24V				
TYPE	MODELS	DIGITS	VOLTAGE	MOUNTING	CONNECTION	
NON-RESET TOTAL COUNTER	MZ - 640 DC12V	6	DC12V	Base (Screw   Vertical)	Lead wire	
	MZ - 640 DC24V		DC24V			
	MZ - 740 DC12V	7	DC12V			
	MZ - 740 DC24V		DC24V			
	MZ - 670 DC12V	6	DC12V	Panel (Snap-in)		
	MZ - 670 DC24V		DC24V			
	MZ - 770 DC12V	7	DC12V			
	MZ - 770 DC24V		DC24V			
	MZ - 602 DC12V	6	DC12V	PCB (Screw   Mounting Pitch : 15 mm [0.59 "])		Terminal pin ( Pitch : 12.7 mm [0.5 "])
	MZ - 602 DC24V		DC24V			
	MZ - 702 DC12V	7	DC12V			
	MZ - 702 DC24V		DC24V			
	MZ - 612 DC12V	6	DC12V	PCB (Screw   Mounting Pitch : 20 mm [0.79 "])		Terminal pin ( Pitch : 10 mm [0.39 "])
	MZ - 612 DC24V		DC24V			
MZ - 712 DC12V	7	DC12V				
MZ - 712 DC24V		DC24V				

## SPECIFICATIONS

Display	6 digits : 3.0 x 2.0 mm [0.12 x 0.08 "] / 7 digits : 3.0 x 1.6 mm [0.12 x 0.06 "] (white on black background)
Power Source	DC 12V, 24V
Voltage Fluctuation	-15 - +10%
Power Consumption	1.2 W
Continuous Energizing	Permissible
Counting Method	One pulse - One count (energizing - ½ count, unenergized - ½ count )
Counting Speed	20Hz
Pulse Width	50msec. minimum
Make (Duty)	1 : 1
Count Life	6 digits : 3,000,000 counts minimum / 7 digits : 10,000,000 counts minimum
Reset	None
Connection	Lead wire 265 mm [10.43 "] / PCB Type: Pin
Operating Temperature	-5°C - +40°C [23 - 104 °F] (non-freezing)
Operating Humidity	85%RH maximum (non-condensing)
Test Voltage	AC1,500V for 1 minute
Insulation Resistance	50MΩ minimum (500VDC megger)
Vibration	Endurance : 16.7 Hz, Width : 4mm [0.16 "] ; XYZ each direction for 1 hour Malfunction : 10 - 55 Hz, Width : 0.5mm [0.02 "] ; XYZ each direction for 10 mins.
Shock	Endurance : 294 m/s <sup>2</sup> (30G) XYZ 5 times each direction, Total : 30 times Malfunction : 49 m/s <sup>2</sup> (5G) XYZ 4 times each direction, Total : 24 times
Construction	Cover : Plastic (Black)
Weight	Approx. 30 grams [1.06 oz]

# DIMENSIONS - MILLIMETERS [INCH]

## MZ - 600 • 700

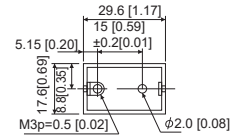
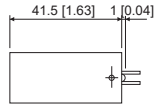
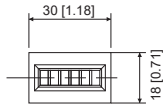

## MZ - 610 • 710

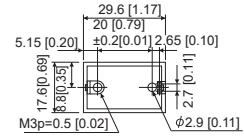
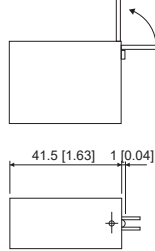
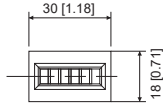

Lead wires can exit out of the side and the rear.

## MZ - 620 • 720

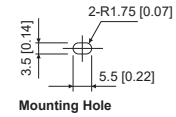
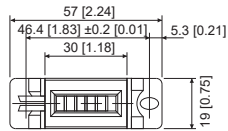

Mounting Hole

## MZ - 630 • 730

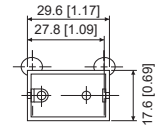
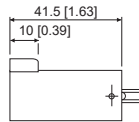
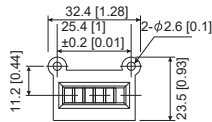

## MZ - 640 • 740

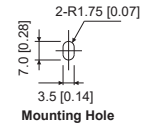
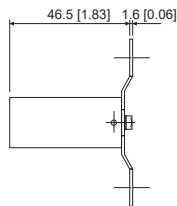
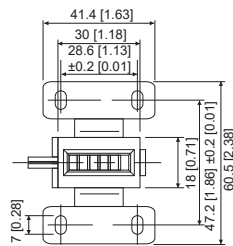
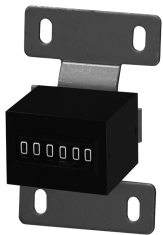

Mounting Hole

## MZ - 670 • 770

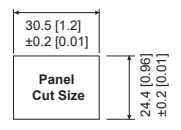
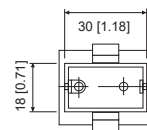
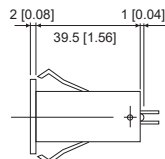
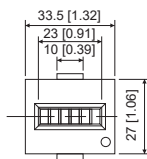

Panel Cut Size

## ■ DIMENSIONS - MILLIMETERS [INCH]

### MZ - 602 • 702

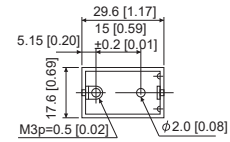
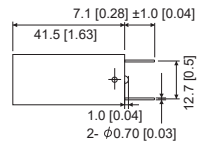
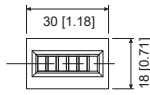

### MZ - 612 • 712

