

# MCH SERIES

## ELECTRIC TOTALIZING COUNTER

- Small size electric counter with push button reset
- Economical, Lightweight
- Available in 3, 4, 5 & 6 Digits with different mounting options
- Applications : Business Machines, Vending Machines, Printing Press, Amusement Equipments, and all kinds of leased machines used for recording counts of movements

### MODEL SELECTION

TYPE	MODELS	DIGITS	MOUNTING	WEIGHT
Additive Total Counter	MCH – 3P	3	Panel	130 grams
	MCH – 4P	4		140 grams
	MCH – 5P	5		160 grams
	MCH – 6P	6		180 grams
	MCH – 3X	3	Bail	110 grams
	MCH – 4X	4		120 grams
	MCH – 5X	5		140 grams
	MCH – 6X	6		140 grams
	MCH – 3S	3	Rear	100 grams
	MCH – 4S	4		110 grams
	MCH – 5S	5		130 grams
	MCH – 6S	6		133 grams

### SPECIFICATIONS

Power Source	AC 100V, 200V 50/60 Hz convertible / DC 6V, 12V, 24V
Voltage Fluctuation	±10%
Power Consumption	AC : 3.8 ~ 4.0VA ; DC : 2.2 ~ 2.8W
Continuous Energizing	Less than 5 minutes
Counting Method	One pulse – One count (energizing – ½ count, unenergized – ½ count )
Counting Speed	15 Hz (maximum)
Pulse Width	33msec. minimum
Make (Duty)	1 : 1
Display	3.8 × 1.6mm (white on black background)
Reset	Manual Reset (push button)
Connection	Lead Wire (250 mm)
Operating Temperature	-5°C ~ +40°C (non-freezing)
Operating Humidity	45 ~ 85% RH (non-condensing)
Test Voltage	AC1,500V for 1 minute
Insulation Resistance	20MΩ minimum (DC500V megger)
Vibration	Endurance : 16.7 Hz, Width, double amplitude 4mm Mismovement : 10 ~ 55 Hz, double amplitude 0.5mm
Shock	Endurance : 300 m/s (30G) / Mismovement : 50 m/s (5G)
Construction	P Models : Plastic Panel (Noryl), Black ; Metal Cover / XModels: Gray Noryl / S Models : Black Noryl

# DIMENSIONS

MCH-3P

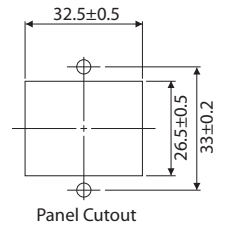
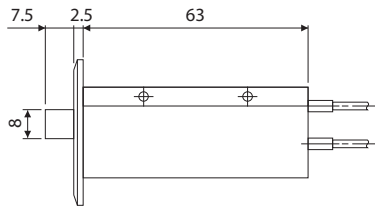
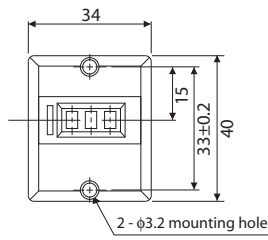
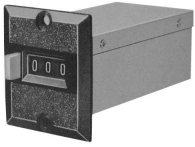

MCH-4P

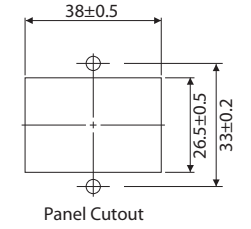
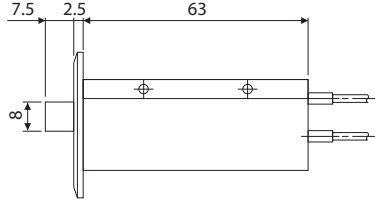
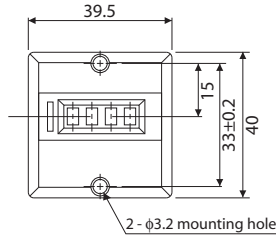
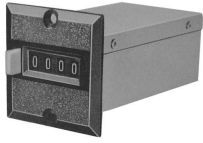

MCH-5P

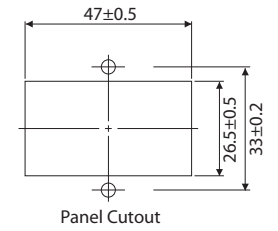
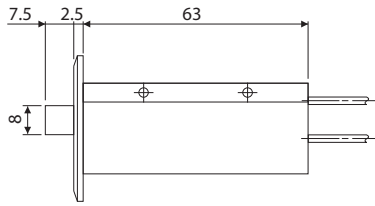
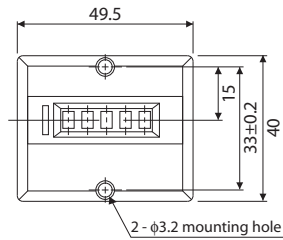
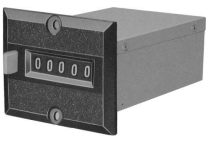

MCH-6P

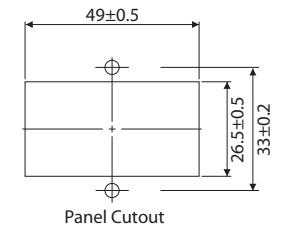
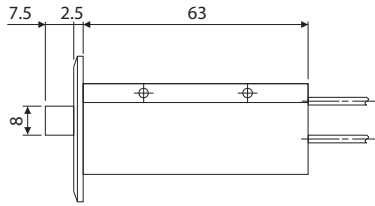
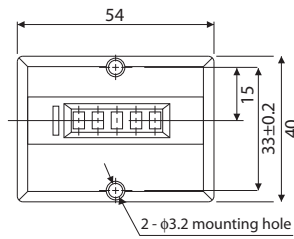
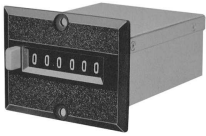

MCH-3X

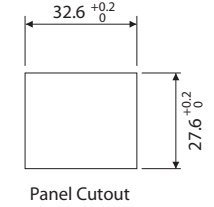
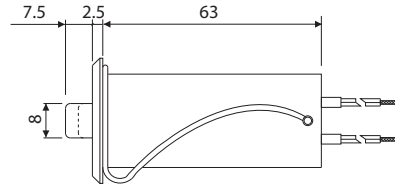
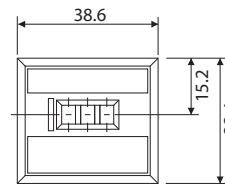

MCH-4X

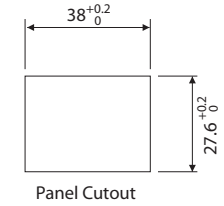
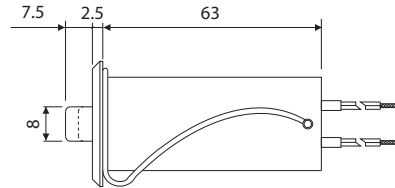
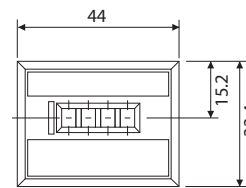

MCH-5X

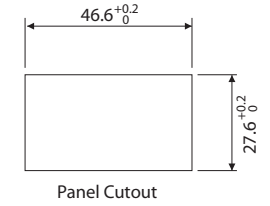
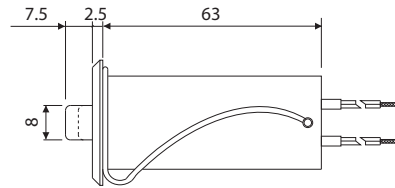
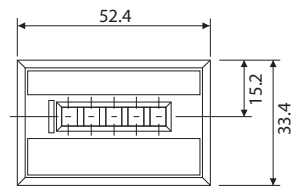

MCH-6X

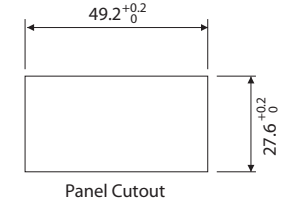
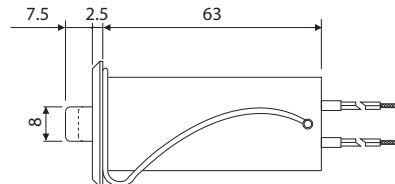
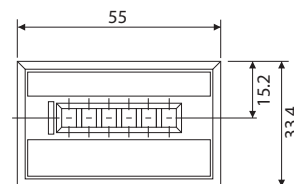

MCH-3S

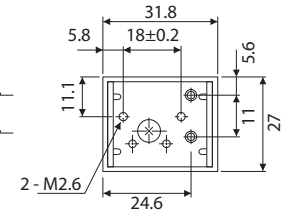
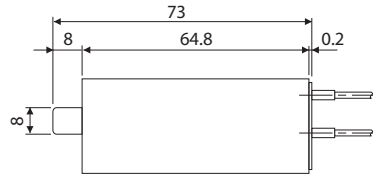
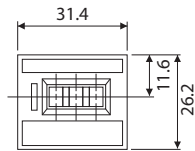

MCH-4S

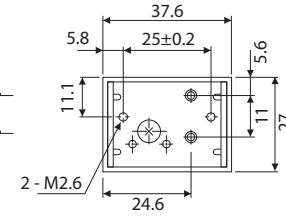
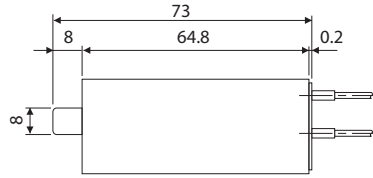
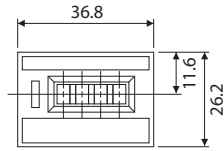

MCH-5S

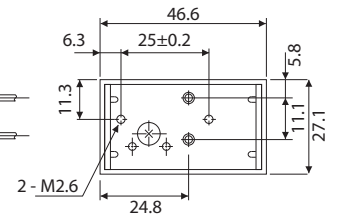
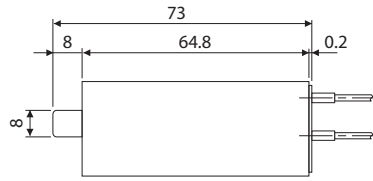
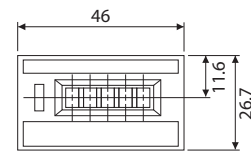

MCH-6S

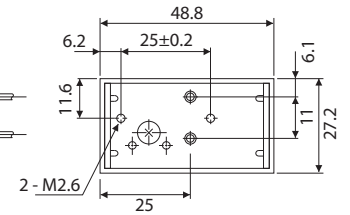
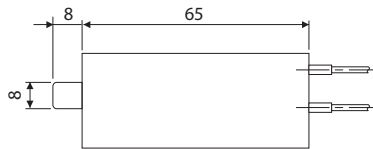
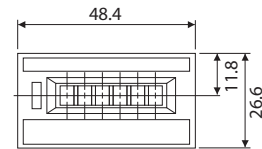
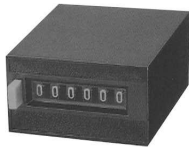

\* Specifications Subject to Change Without Prior Notice  
 All Rights Reserved, Copyright © 2003 Line Seiki Co., Ltd.  
 2003.07.11.1260A



**LINE SEIKI CO.,LTD.**

Address : 37-7, Chuo-Cho, 2-Chome, Meguro-ku  
 Tokyo 152-0001 JAPAN  
 Contacts : Tel: +81-3-3716-5151 Fax: +81-3-3710-4552  
 E-mail: sales@line.co.jp  
 URL : <http://www.line.co.jp>