

Production on order

This product is for the machine manufacturers contracted with us.
We do not sell to general users and repairers.

LINE SEIKI

SD-42

Limit Switch

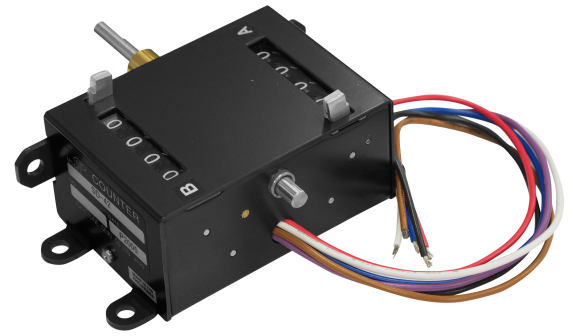

- Ideal for various infrastructure equipment such as electric shutters, jacks, valves, etc.
- Mechanical limit switch that stops the motor at the upper and lower limits.

Specifications

No. of Digits	4
Size of figure	4.3 x 2.8 mm
Ratio (Rotation : Counts)	10 counts per main shaft rotation
Maximum Rotation Speed	500 RPM
Output Capacity	AC250V 3A
Ambient Temp. : Operating	-20 - +70°C (Should not be frozen)
Ambient Humid. : Operating	85%RH max. (Non-condensing)
Mounting	Flange-mounted / Base-mounted

How to set upper and lower limit positions (Refer to the arrows ↑ ↓ in the external dimensions)

1. Push the reset button in the direction of arrow horizontally and keep holding down the button. Put the notch of the reset button under the window plate to fix it at free position.
2. Please rotate the shaft and move it to the position where you want to stop the motor.
3. Hold down the reset button while pushing it in the direction of arrow horizontally.

Dimensions [mm]

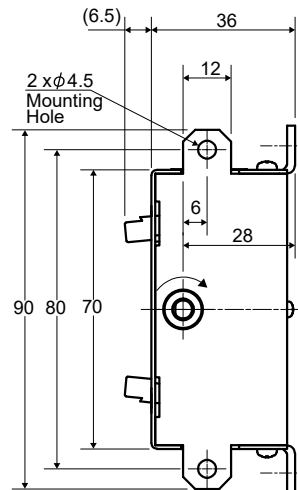
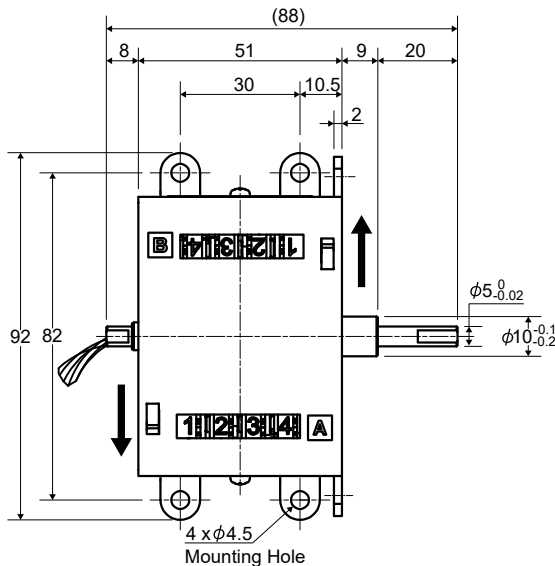

Digit Size [mm]

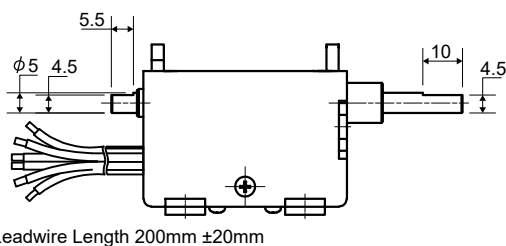
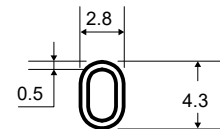

Leadwire Length 200mm ±20mm

Micro Switch Wiring Diagram

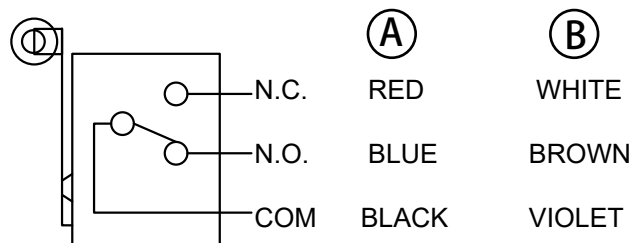

This catalog was last revised Aug. 27, 2021.

*Subject to change without prior notice.

All Rights Reserved, Copyright © 2021, LINE SEIKI CO., LTD.



LINE SEIKI CO., LTD.

37-7 Chuo-cho, 2-Chome
Meguro-ku, Tokyo 152-0001 Japan
Please visit our company website for contact details
webtrade@line.co.jp
<https://www.lineseiki.com>